

PRORIL

60Hz

GOSPIN Series, the classical drainage pumps with strainer and rigid casting are engineered for various effluent pumping applications in commercial and industrial sectors.

Sewage Pump

GOSPIN 215/315

Drainage Pump



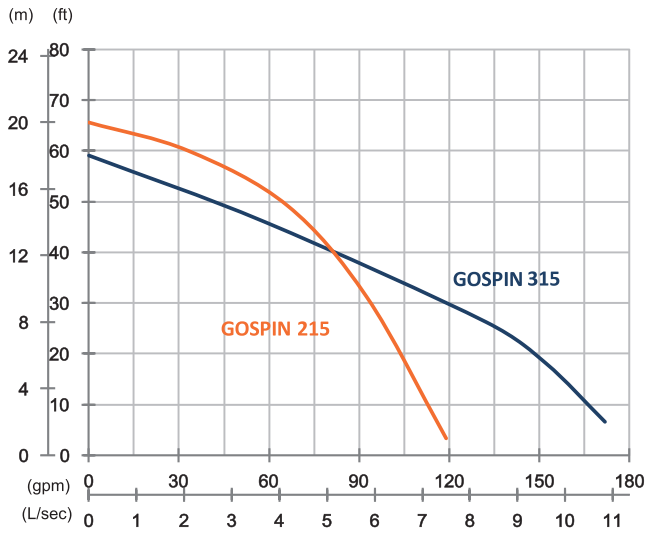

	GOSPIN 215	GOSPIN 315
OUTPUT	2 HP (1.5 kW)	2 HP (1.5 kW)
OUTLET	2" (50 mm)	3" (80 mm)
SOLID PASSAGE	0.3" (7 mm)	0.3" (7 mm)
Weight	51 lbs/23 kg	51 lbs/23 kg
HEAD	Rated: 49 ft, 15 m Max: 66 ft, 20 m	Rated: 26 ft, 8 m Max: 59 ft, 18 m
FLOW	Rated: 66 gpm, 4.2 L/s Max: 119 gpm, 7.5 L/s	Rated: 132 gpm, 8.3 L/s Max: 172 gpm, 10.8 L/s

Pump Type	Electric Submersible Pumps	
Motor	Phase	1-Phase, 3-Phase
	Type	Induction Motor
	Poles	2 Pole (3450 rpm)
	Insulation	Class F
	Protector	Circle Thermal Protector
	Starter	1-Phase · Capacitor-Run, 3-Phase · D.O.L.
Lubricant	Food Grade (ISO VG32)	
Specs.	Impeller Type	Semi-Open
	Shaft Seal	Double Mechanical Seal Silicon Carbide VS Ceramic/Carbon
	Bearings	C3 Shielded ball bearings
	Cable	CSA-Certified PVC Jacketed Cables 33 ft (10 m) or longer upon request
Materials	Pump Casing	Gray Iron
	Impeller	Gray Iron
	Motor Frame	Gray Iron
	Motor Shaft	Stainless Steel
	Strainer	Stainless Steel
Max. Liquid Temperature	40°C (104°F)	
Max. Submersion Depth	20 m (66 ft)	
pH Range	pH 5 - pH 8	
Guide Rail	GRL-02F (215)/GRL-03F (315)	

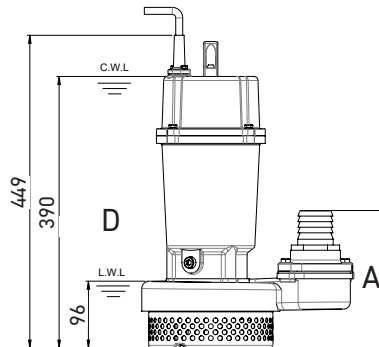
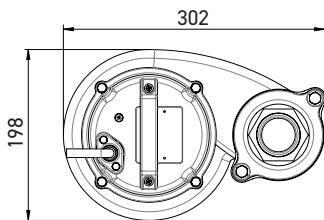

	A
GOSPIN 215	198
GOSPIN 315	234

unit : mm
C.W.L : Continuous running water level
L.W.L : Lowest running water level